



## Materials for the FAT HAT Only:

- denim hat with floppy brim
- snaps
- quick tack glue
- beading needle (sizes 10 - 13)
- 10" of dark blue beading thread
- 8" of dark blue floss
- embroidery needle (size 5)
- instant glue

## LAMB Says...

Adjust the distance between the snaps to 5" to accommodate both hat band and headband widths! We are using 3" between the snaps to accommodate the hat band only.

## Step-by-Step Illustrations

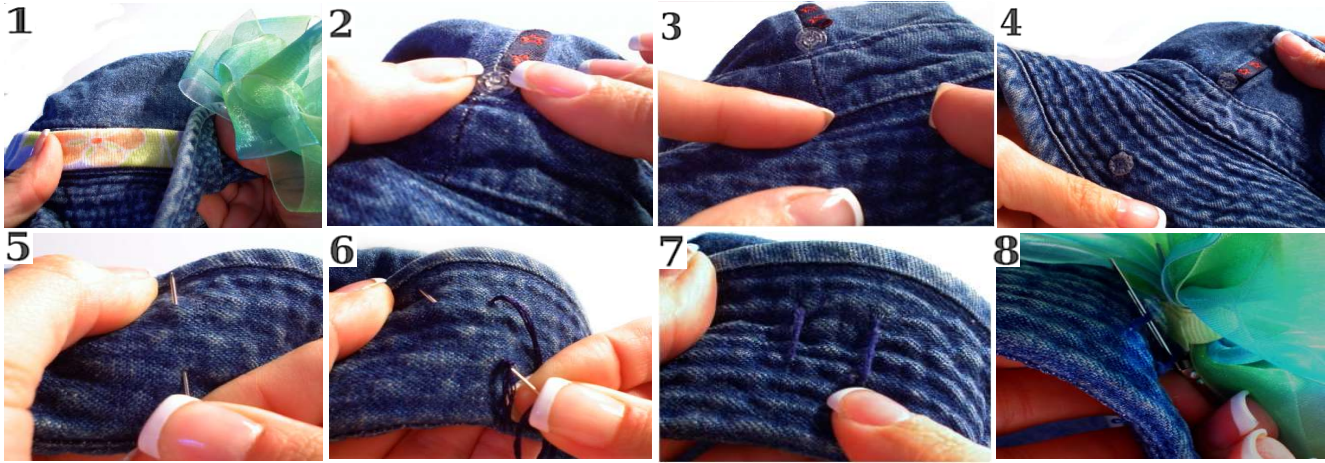

## LAMB's Flip And Turn Hat (FAT HAT)

- 1.** To create a hat band, follow "Interchangeable Fabric Headband" on page 9, but use a fabric width of 2 ½" instead of 4". The finished hat band will be about 1" wide.
- 2.** Find the spot where you'll want to flip up the brim (LAMB uses the backside of the hat where the hat tag is usually located). Use a quick-drying glue to tack the snap (with knob) below the tag, right above the hat band (or about 1 ½" from the brim, if there is no band already on the hat).
- 3.** Glue the other snap (with hole) on the brim about 3" directly under where the other snap is located.
- 4.** Staying between the double layered fabric, permanently attach snaps with your beading needle and matching thread (same color as hat) by sewing the snap on. When you are ready to tie off the thread, run the needle up under the snap (between the double layered fabric) so it comes out right under the snap. Tie a double knot. The knot should be under the snap. Dot the knot with instant glue.
- 5.** Flip the brim up and use your embroidery floss and needle to make your slide hole. Leaving a 1 ½" tail after the knot, tie a knot on **one** end of the floss. Find your center point on the brim, usually ¼" on each side of the snap on other side of the brim. Run the needle between the double layered fabric about ½" wide, while making sure that the length of the stitch is **centered** to the snap on other side. Pull the needle and floss through.
- 6.** Re-enter needle in **first** hole and angle it so the needle comes out about ¾" away from where the floss came through the last hole. Pull the needle and floss through.
- 7.** Make a new hole ½" away from the first hole. While keeping the needle between the double layered fabric, **TURN** the needle towards the first hole (where the knot is located) and pull floss through. Tie the **two** pieces of floss together into a **double** knot. Then seal the knot with instant glue and cut off excess floss.
- 8.** Simply use this slide hole to clip on fashion accessories. To do this, slide the bottom prong of the clip through the 2 vertical ½" slots (slide hole) you made with the floss. Fasten or close the clip, and you are ready to go!